

Haus D

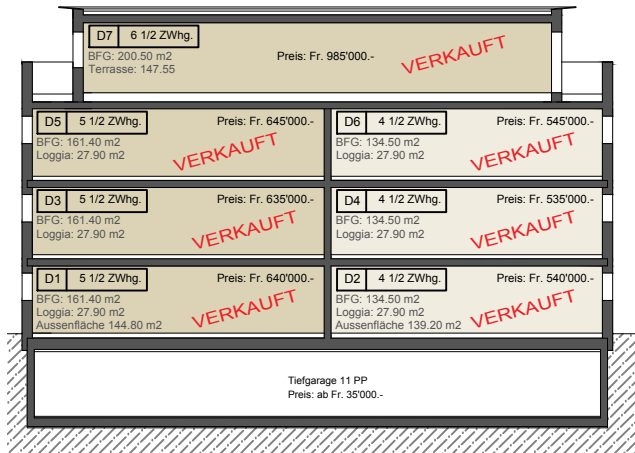

Haus E

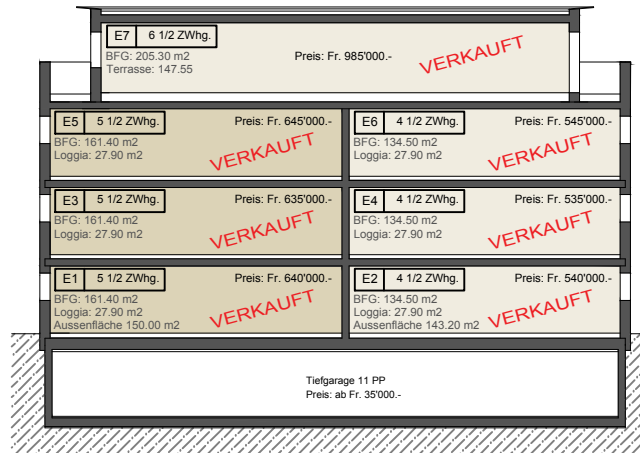

Haus F

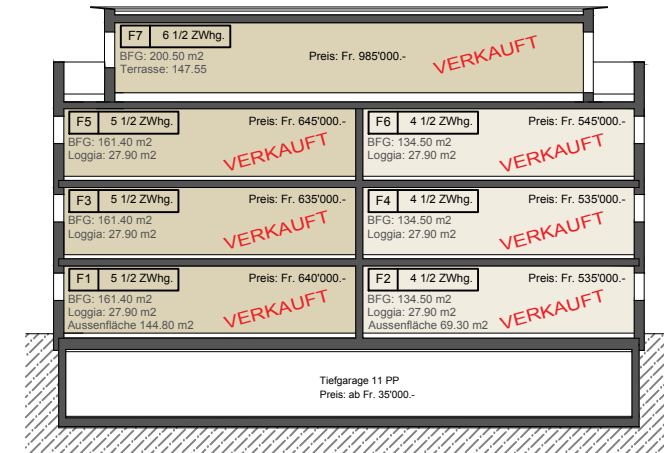

15 Aussenparkplätze
Preis: je Fr. 15'000.-

Preisliste

Wohnüberbauung

Binapark 2. Etappe, Visp West

Projekt / Planung:

bpm SCHMIDT

Postfach 520 CH 3930 Visp
t.: 027 946 03 16 f.: 027 946 03 17

© 29.08.2017 / SK